

P & H Elevator Preservation Society

Spring 2016

Celebrating Our Eleventh Year

Issue # 22

Pancake Breakfast Fundraiser



Where: P & H Elevator

When: May 29th

Time: 8:30 am to 1:00 pm

What's Happening:

Threshing Demonstration
using the Little Giant™ and the
1912 Elevator Engine

Rope Making Demonstration and Display

Flour Making
with Stone Grist Mill

Everyone Welcome!

<http://www.stettlergrainelevator.com>

stettlergrainelevator@gmail.com

What's Happening at the P & H Elevator?

The year has been busy to date and we have much more planned going forward

Christmas Party: We started the year with our annual winter get-together. We were pleased with the 120 folks that came out for an enjoyable evening.

Trade Show: We again had a booth in the Stettler Trade Show. We were pleased with the interest and support coming from the public. The stone ground flour mill demonstration generated considerable interest.

Alberta Prairie Season Opener May 14: The season opener went well with a number of visitors to the elevator and snack bar. We have completed our spring cleaning and planning for the approximately 60 excursions (train days) where we are open for tours of the Elevator complex and operate the "Snack Bar" located near the Alberta Prairie station.

Drive Thru Doors: We are working on the main drive thru doors that were destroyed by a rogue wind last fall.



Finishing touches and another coat of paint will be applied.

Pancake Breakfast: On May 29th we will be hosting the Pancake Breakfast Fund raiser. The donations from this event will be used entirely for the Feed Shed addition.

Stettler Stampede Parade: We plan to put an entry in the Parade June 11th. The entry will include the horse drawn wagon, the Elevator engine and the “Little Giant” threshing machine.

Summer Student: We have been approved for a summer student under the Service Canada Hire a Summer Student program. This program is a cost sharing program. We are presently looking for a suitable candidate. As in the past this student will be a great help to us.

School Tours: We have school tours booked for May and June. We are expecting 200 plus students to visit and tour the Elevator complex. We are pleased to welcome them and teach them about Agriculture and where some of their food comes from.

Annex Bin: We have put a doorway into an annex bin. This allows visitors to enter the bin and gain an understanding of how Elevators are constructed and the means of filling and emptying the 30 plus grain bins. The picture shows a 2500 bushel bin 75 feet in height and the construction showing the corner braces to provide support for the corners and walls. This bin full of wheat would weigh 150,000 lbs. or 75 tons or be equivalent to 50 (3000 lb.) cars.

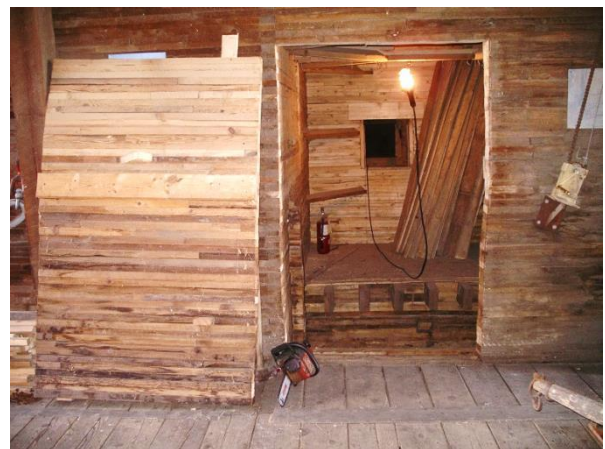

Entrance to Annex Bin



Inside the Bin - Looking Up to the top of the Annex

Coffee Stop
Tuesday, Wednesday and Thursday
9:00 --- 11:00
Everyone Welcome



Feed Shed Addition: The major building plan for this year is to start the Feed Shed addition (which will provide a heating system for the existing feed shed and new addition, badly needed washrooms and a larger area for the Coffee Stop). We do not have all the funds to complete the project but we feel we should get started and then complete the building and finishing touches over the next year or two. Most of the work will be contracted but we hope to be able to do some of the work ourselves – this will depend on the availability of volunteers.

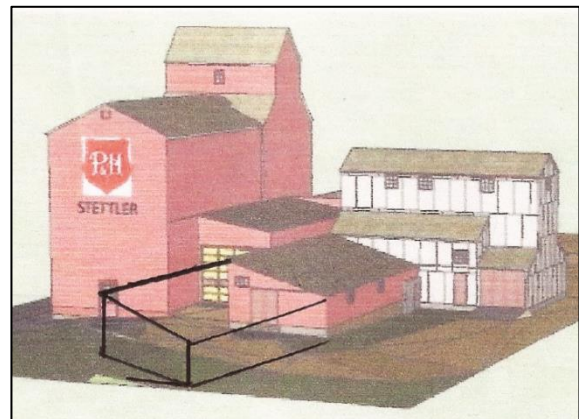

40 Feet

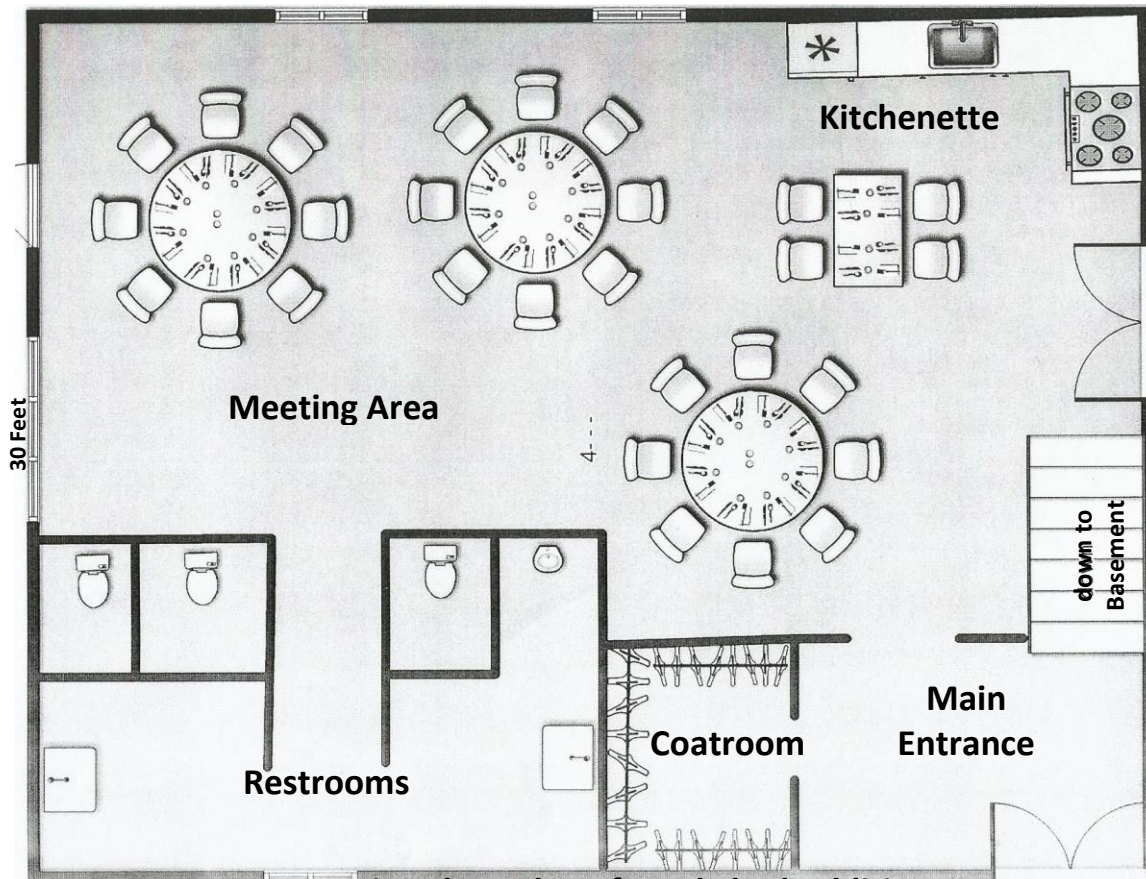

Tentative Floor Plan of Feed Shed Addition



Summer Tours: The Elevator complex will be open for tours on train days and most other days of the week during the summer. Threshing demonstrations will be carried out a number of times during the summer.

Sunshine Combine: Restoration of the combine continues. The engine and the header have been completely restored.



Volunteers & Work Bees: We are in serious need of more volunteers to help carry out the many activities we are working on. We will match activities to your interests. A real sense of accomplishment is realized when one can look back and see the results of their efforts. These results can be enjoyed now and by future generations. WORK BEES are on Saturdays, but other days as well, when required. Stop by for a coffee and to see what we are working on.

In Memorium: The following names have been added to our Memorial Board.

	<i>Sponsor</i>
<i>Paul & Anna Scheerschmidt</i>	Karen Fischer
<i>Juri & Marie Klaus</i>	Evelyn Shursen
<i>Paul & Agnes Klaus</i>	Evelyn Shursen
<i>Coy McKay</i>	Donna McKay
<i>Archie & Edith White</i>	Ray & Alice White
<i>Jim Scheerschmidt</i>	Albert & Jean Bauer

An Invitation: If you are in the vicinity please stop for a coffee at the "COFFEE STOP" or the SNACK BAR" for the best Hot Dogs in Town

Memberships: Thank you to everyone who has paid their annual dues. If you haven't paid your dues we would appreciate your support for another year. All dues and donations will go toward the Feed Shed Addition.

P & H Elevator Society
 Box 1437, Stettler, AB. T0C 2L0
 Membership 2016
 Annual - \$20.00, Lifetime - \$150.00

Name: _____

Address: _____

Postal Code: _____

Telephone: _____

Email: _____

